

LOCATION PLAN1: Scale 1:10,000

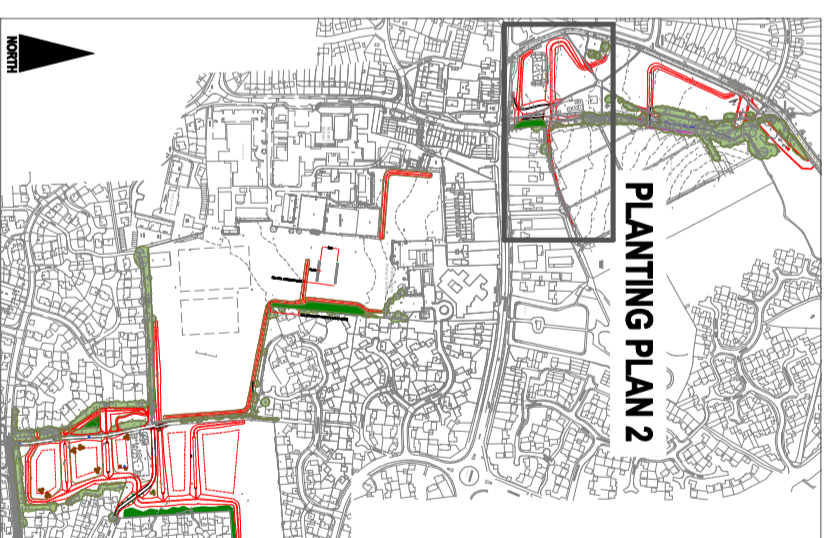

KEY

Proposed engineering work associated with the Flood Alleviation Scheme

Existing trees to be retained

Proposed native wildflower and grass seed mix suitable for a neutral to acid soil. to include plant species as follows: Autumn Hawkbit, Birdsfoot Trefoil, Common Cat's Ear, Corn Devil Bits, Lady's Bedstraw, Meadow Buttercup, Musk Mallow, Ox Eye Daisy, Red Campion, Ribwort Plantain, Self Heal, White Campion, Wild Carrot, Yarrow, Yellow Rattle.

Proposed native wildflower and grass seed mix suitable for neutral damp areas to include plant species as follows: Devils-bit scabious, Ragged Robin, Yarrow, Wild Carrot, Common Knapsweed, Birdsfoot Trefoil, Meadow Buttercup, Creeping Buttercup, Wild Red Clover

Proposed native shrub mix, to include Hawthorn (40%), Blackthorn (10%), Hazel (20%), Holly (10%), Willow (20%). Planted on 1.5m grid, notched planted, transplants 40-60cm

Quercus palustris Extra heavy standard 16-18cm girth. Plant as row on western boundary

Sorbus aucuparia Heavy standard 12-14cm girth plant in groups throughout area

Prunus avium Heavy standard 12-14cm girth Plant on grid to replicate orchard character

Betula pendula Heavy standard 12-14cm girth Plant in groups, 4m apart

Quercus robur Heavy standard 12-14cm girth Plant as specimen trees

Pinus sylvestris Heavy standard 12-14cm girth Plant in irregular groups throughout site

NOTES FOR DUNSTAN GREEN: Concept for proposed planting: Integrate and reduce the visual impact of the proposed bunds as well as creating a new identity for Dunstan Green by proposing a strong planting design, as follows:

1. Propose new landscape character which compliments urban location and reinforces the link of the wooded culvert to the countryside further to the north
A formal row of trees will be planted adjacent Harts Hill Road Road, which will also create a defining edge to Dunstan Green, as well as Improving the landscape character of the Road and reducing the visual impact of the proposed bunds

2. Increase biodiversity by using native plants
A further mix of native tree species will be planted (as found within this landscape character area) in irregular groups, building on the existing wooded landscape character of the existing tributary. Native wildflower and grass seed mixes will be sown to further increase biodiversity, with a specific seed mix for damp areas adjacent the tributary.

3. Improve biodiversity of grassland areas:
A native wildflower and grass seed mix will be sown on the bunds and additional adjacent areas, with a reduced mowing regime this will create attractive swathes of wildflowers and a contrasting texture providing additional year long visual interest as well as improved biodiversity

TITLE
Landscape Scheme - Proposed Planting: SHEET 2 OF 6

CLIENT
West Berkshire Council

PROJECT
South East Thatcham, Flood Alleviation Scheme

SCALE As shown @A3
DATE 12th September17
DRAWING REF KLP / 276 / 17 / 02

DRAWN BY LA
APPROVED BY BK

KirkhamLandscapePlanning Ltd



PLANTING PLAN 1: Scale 1:1000